

Edenfield Pump track Location Plan

Scale 1:1250@A3

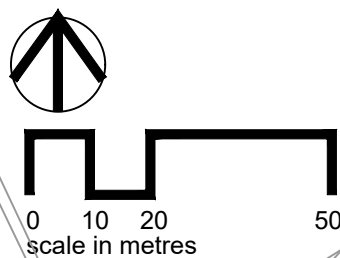
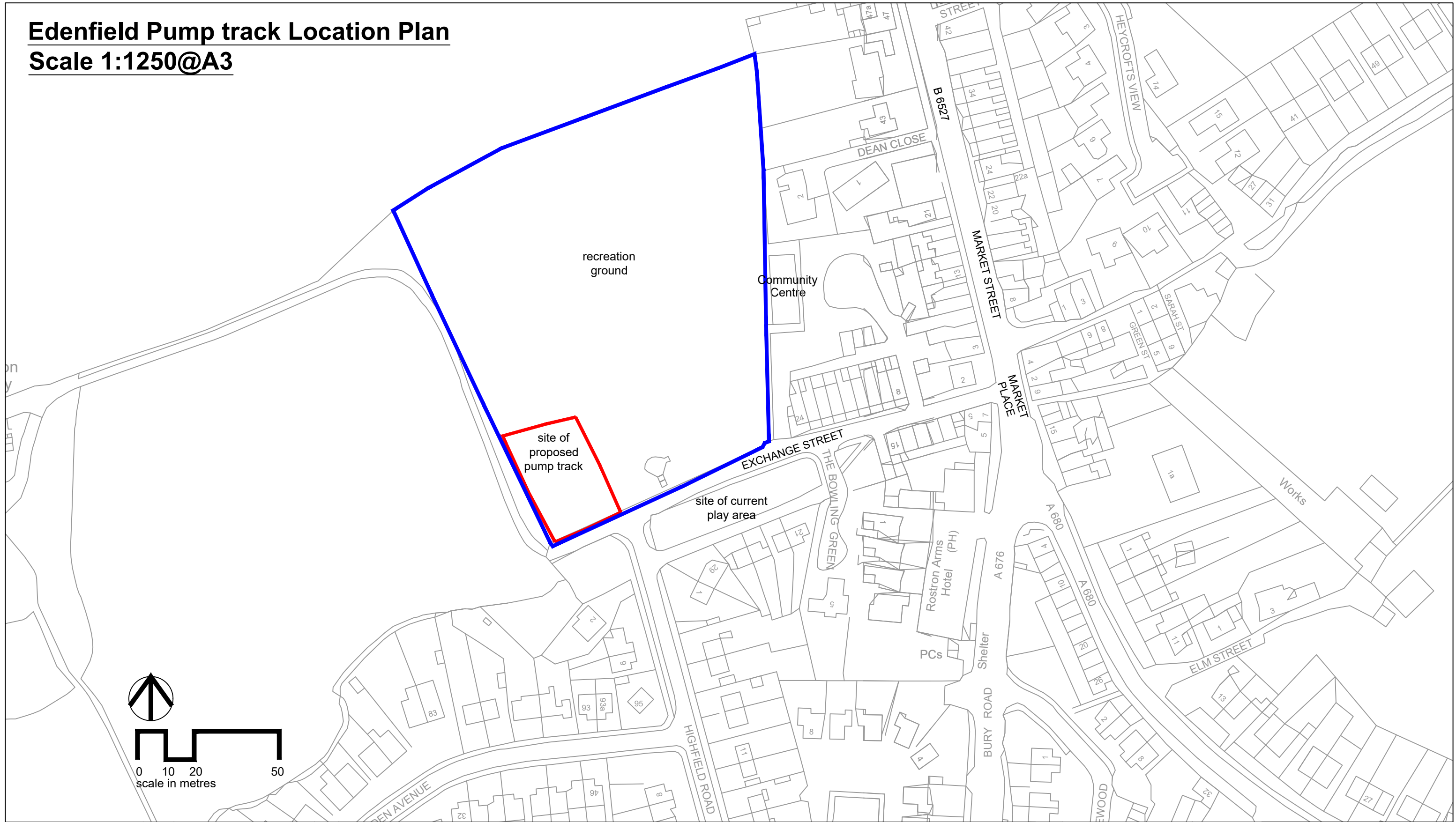

Notes
 1) Figured dimensions to be taken. Do not scale dimensions. Contractors must verify all dimensions on site before preparing shop drawings or commencing any work.
 2) Copyright © This drawing must not be reproduced without the permission of Proffitts CIC
 3) Reproduced from 1998 Ordnance Survey mapping with permission of the controller of HMSO.

DATE	REVISION NOTES	ISSUE	CHKD
14.12.21	v1 - confirmation of boundaries		

DESIGN	PLANNING	TENDER	CONTRACT

PROFFITTS - INVESTING IN COMMUNITIES
 Tel: 01204 778907
 email: communities@proffittscic.com
 twitter: @proffittscic
 www.proffittscic.com

CLIENT RBC/Edenfield Residents			
PROJECT Edenfield Play Area			
TITLE Location Plan v1			
SCALE 1:1250@A3	DATE Sep 2021	DRAWING NO. 165/L01 v1	
DRAWN BY RG	CHECKED BY MP	PROJECT CODE 165	ISSUE



ADVANCED

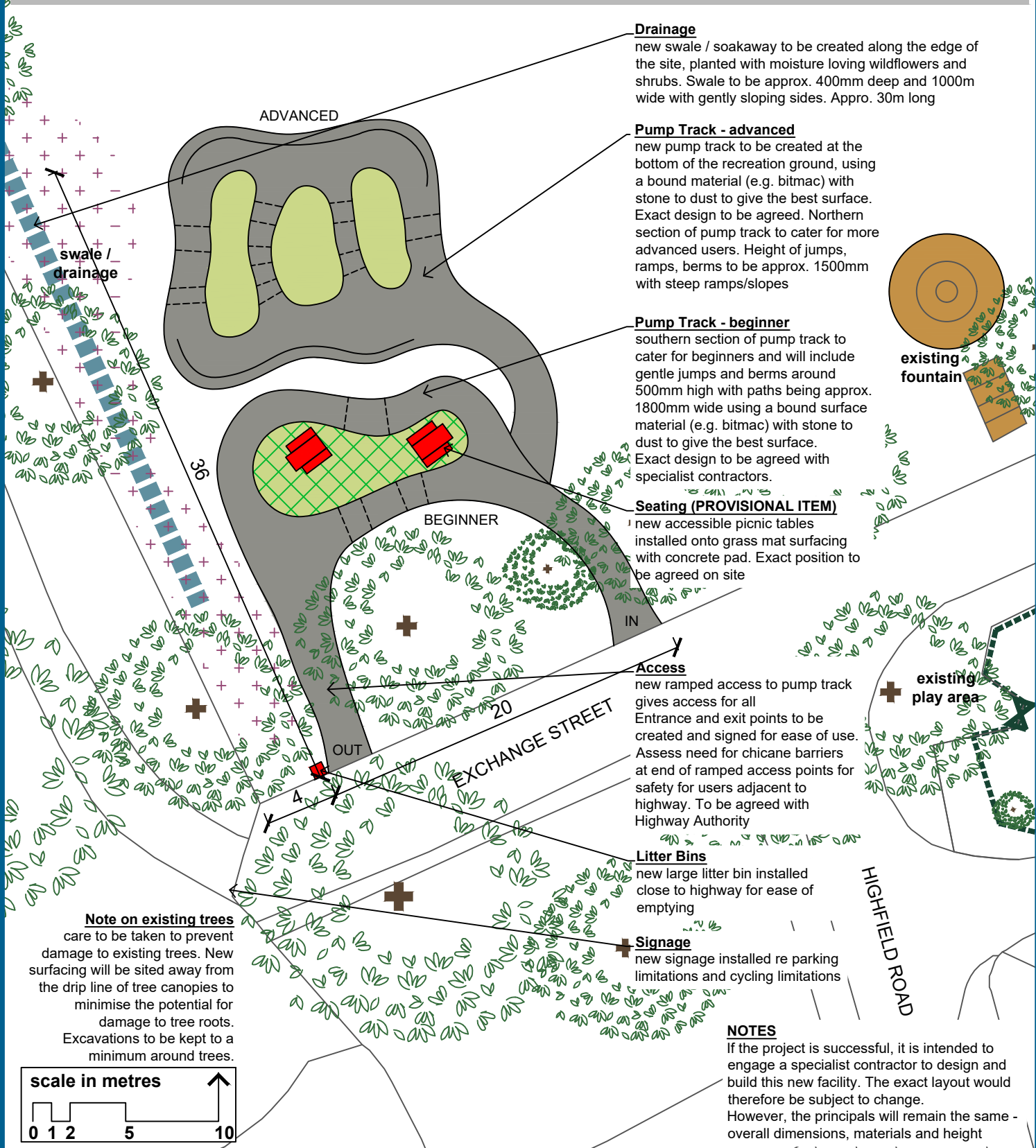
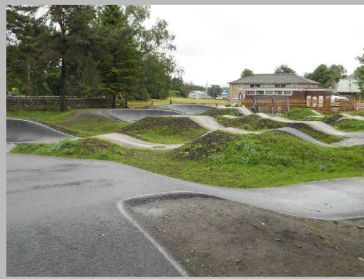

Drainage

new swale / soakaway to be created along the edge of the site, planted with moisture loving wildflowers and shrubs. Swale to be approx. 400mm deep and 1000m wide with gently sloping sides. Apprx. 30m long

Pump Track - advanced

new pump track to be created at the bottom of the recreation ground, using a bound material (e.g. bitmac) with stone to dust to give the best surface. Exact design to be agreed. Northern section of pump track to cater for more advanced users. Height of jumps, ramps, berms to be approx. 1500mm with steep ramps/slopes

Pump Track - beginner

southern section of pump track to cater for beginners and will include gentle jumps and berms around 500mm high with paths being approx. 1800mm wide using a bound surface material (e.g. bitmac) with stone to dust to give the best surface. Exact design to be agreed with specialist contractors.

Seating (PROVISIONAL ITEM)

new accessible picnic tables installed onto grass mat surfacing with concrete pad. Exact position to be agreed on site

Access

new ramped access to pump track gives access for all. Entrance and exit points to be created and signed for ease of use. Assess need for chicane barriers at end of ramped access points for safety for users adjacent to highway. To be agreed with Highway Authority

Litter Bins

new large litter bin installed close to highway for ease of emptying

Signage

new signage installed re parking limitations and cycling limitations

NOTES

If the project is successful, it is intended to engage a specialist contractor to design and build this new facility. The exact layout would therefore be subject to change. However, the principals will remain the same - overall dimensions, materials and height

Note on existing trees

care to be taken to prevent damage to existing trees. New surfacing will be sited away from the drip line of tree canopies to minimise the potential for damage to tree roots. Excavations to be kept to a minimum around trees.

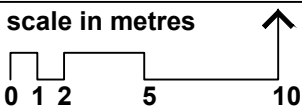

	existing trees		swales/drainage
	bitmac/stone surfacing		litter bin
	wildflowers		picnic tables and seats

edenfield pump track sketch design v3



nov 2021

not to scale



