

Notes: Do not scale from this drawing. This drawing is to be read in conjunction with all relevant design team specifications and drawings.
 All dimensions are to be checked on site prior to commencement of work any variations to be notified to the Project Architect.
 All components and materials are to be stored, protected, handled and installed in accordance with the manufacturer's recommendations.
 © Harry Walters & Livesey Ltd

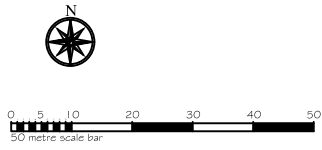

Ordnance Survey, (c) Crown Copyright 2022. All rights reserved. Licence number 100022432



HARRY WALTERS & LIVESEY Ltd

CLIENT James Hall & Co Ltd		PROJECT NAME Spar, Rawtenstall	
DRAWING NAME Location Plan		SCALE 1:1250 @ A3	DRAWN BY JMW
DATE 13-07-2022	JOB NUMBER 605	DWG No PI-002	REV No A

Registered Office • James Hall Spar Distribution
 Centre Bowland View Fulwood • Preston •
 Lancashire • PR2 5QT • Company No. 06235823

K.M. McFadyen, Dip. Arch. R.I.B.A.
 Tel No: 01772 706696
 Email: office@HWL1.com

PLANTING

HEDGING across front boundary –
To be planted in three rows 450mm apart and staggered.

	SPACING	Specification-Size
Blackthorn (Prunus Spinosa)	"900"	"300 – 400"
Hawthorn (Crataegus monogyna)	"900"	"450 – 600"
Field Rose (Rosa Arvensis)	"900"	"300 – 400"

MASS PLANTING – Mass planted in groups of species and chosen from the following:-

	SPACING	Height
Hardy Lavender	750	600 – 700
Rosmerinus "Roman Beauty"	750	600 – 700
Ceanothus impressus	900	600 – 700
Hebe "Margret"	600"	450 – 900

GENERAL NOTES

1. This drawing is to be read in conjunction with all relevant Architects', Engineer's, Specialists, Bills of Quantities and Specifications.
2. The insertion of any firm or proprietary brand on this drawing is an indication of the class or quality required and does not exclude the use of alternative materials that are equal in performance, quality and appearance, provided that they have been approved in writing by the Landscape Architect.
3. The Contractor is responsible for accurately ascertaining the position of underground services and responding to all relevant service easement requirements.
4. All dimensions are in millimetres unless stated otherwise, for the purposes of construction this drawing must not be scaled and only written dimensions used. Written and scaled dimensions to be checked on site, any discrepancies reported prior to work commencing. IF IN DOUBT PLEASE ASK.
5. All work and materials are to be in accordance with the relevant British Standards and Code of Practice.
6. All Proprietary products are to be used strictly in accordance with the manufacturer's instructions and details.

NOTES ON PLANTING

- 1 Topsoil shall be spread to min 450mm depth over planting beds and 150mm depth over turf areas and graded to fall.
- 2 Herbicide and Cultivation: Topsoil to be treated with an application of herbicide prior to planting, where necessary, strictly in accordance with the Control of Pesticides Regulations 1986 (or otherwise updated/superseded legislation), and following manufacturer's instructions by qualified staff. The topsoil shall then be cultivated to 150mm depth.
- 3 Herbicide: Spot treat with herbicide throughout the maintenance period in accordance with the manufacturer's instructions.
- 4 Bark Mulch: On completion of all planting works all shrub areas are to be spread with 50mm depth of 10-35mm grade ornamental maritime bark mulch.
- 5 Position of Plants: Final position of shrubs subject to confirmation of service location and approval of statutory undertakers.
- 6 Watering: Plant only into moist soil and water thoroughly to the full depth of soil immediately after planting. Water regularly through the establishment period (minimum 3 months) to prevent dehydration.

NOTE:

As a minimum, the quality of all hard and soft landscape works shall be carried out in accordance with BS 4428:1989 'Code of practice For General Landscape Operations' or any subsequent revision. All trees and other plants included within the approved details shall be healthy, well formed specimens of a minimum quality that is compatible with BS 3936:1992 (Part 1) 'Specification for Shrubs and BS 4043 or any subsequent revision. Any plants which within a period of 5 years from the completion of the development, die, are removed, uprooted, are significantly damaged or become diseased shall be replaced during the nearest planting season (1st October to 31st March inclusive) with others of the same size, species and quality.

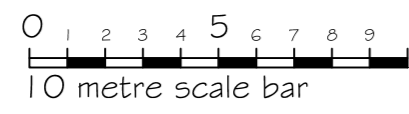

1 Number tree to be planted central to bed:-
Vilmorin's Rowan (Sorbus vilmorinii)
Max height when full grown 5m

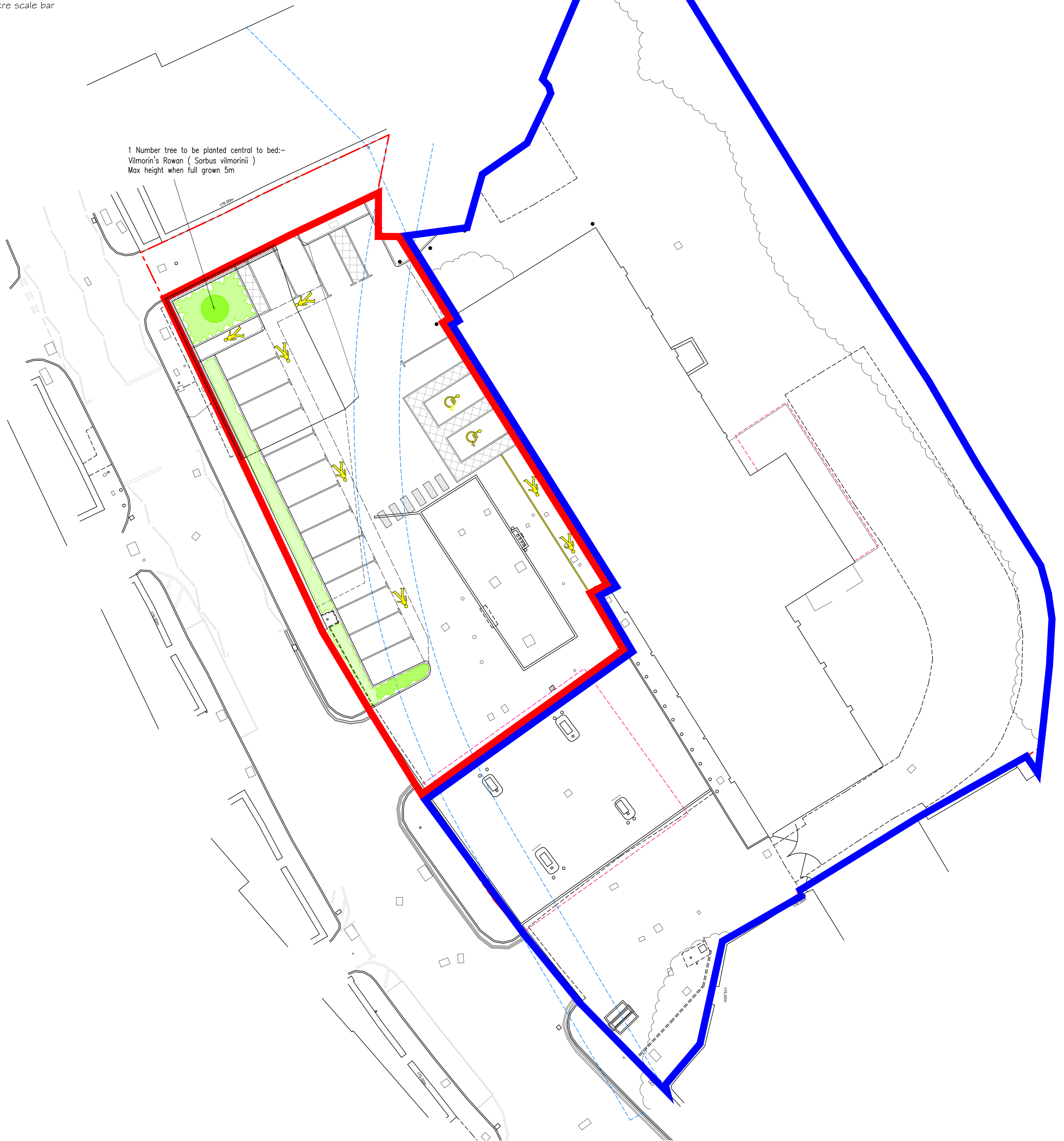

Rev P2 17-10-2022 JMW
Plant species amended to reflect clients comments



CLIENT James Hall & Co Ltd	PROJECT NAME Spar, Rawtenstall	DRAWN BY JMW
DRAWING NAME Proposed Soft Landscaping	SCALE 1:200 @ A1	REV No P2
DATE 13-09-2022	JOB NUMBER 605	DWG No PI-002
Registered Office • James Hall Spar Distribution Centre Bowland View Fulwood • Preston • Lancashire • PR2 5QT • Company No. 0225823		K.M. McFadyen, Dip. Arch. R.I.B.A. Tel No: 01772 706696 Email: office@HWL1.com