

All Saints  
Catholic Language  
College, Rossendale  
Secondary School

SHEET CONTINUES ON 80061155-01-JAC-TR5-97-DR-C-00004

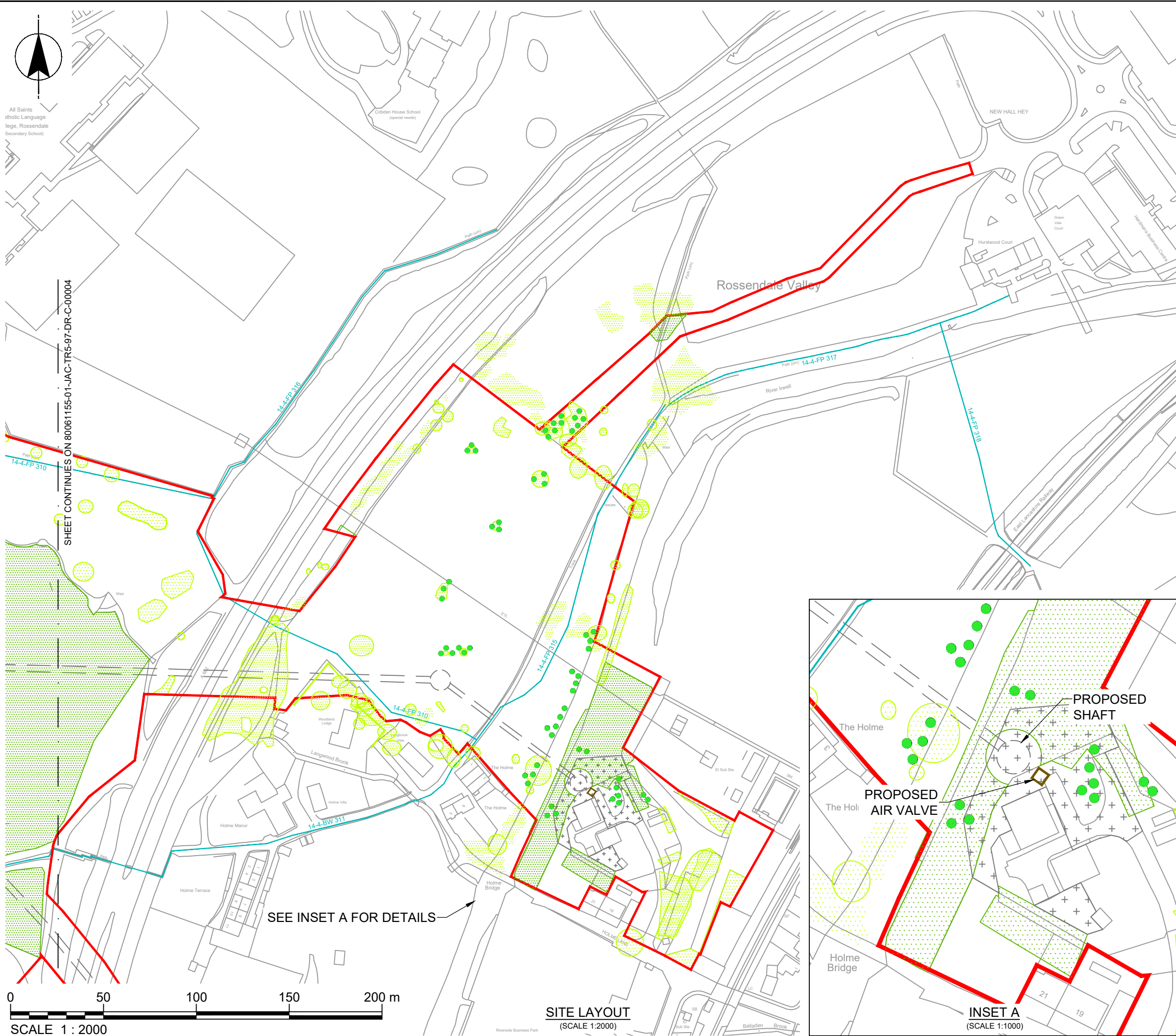

**SITE LAYOUT**  
(SCALE 1:2000)

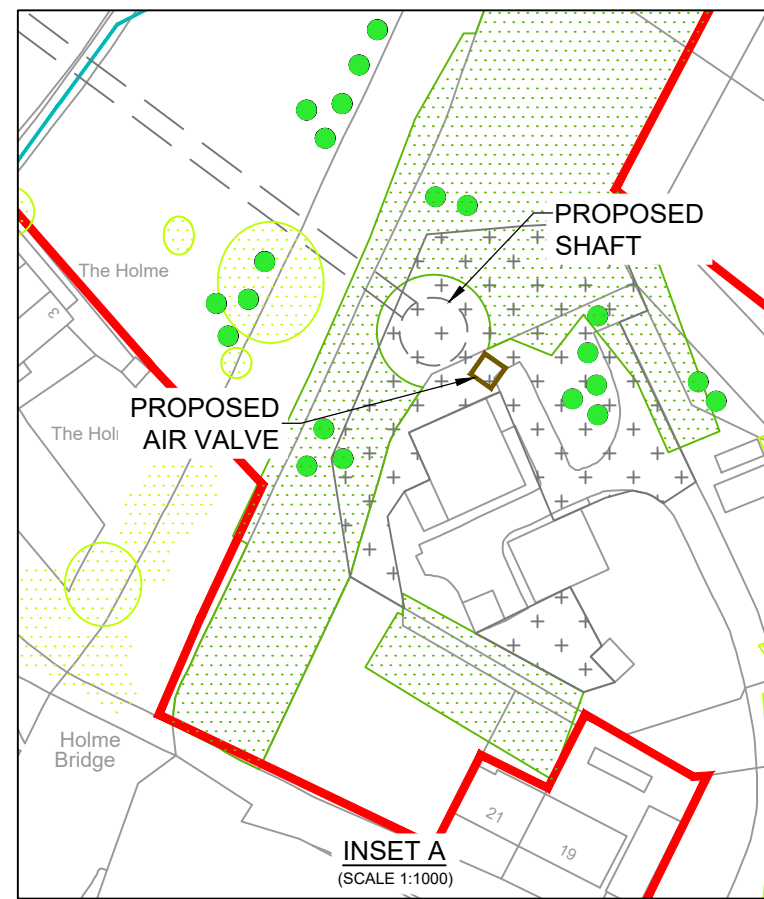

**INSET A**  
(SCALE 1:1000)

**NOTES**

1. ALL DIMENSIONS AND LEVELS IN METRES AOD UNLESS NOTED OTHERWISE.
2. REFER TO THE ENVIRONMENTAL MASTERPLAN FOR DETAILS OF ARBORICULTURAL IMPACTS INCLUDING PROPOSED REMOVALS.
3. ALL BOUNDARY FEATURES SUCH AS HEDGEROWS, STONE WALLS AND FENCES ARE TO BE REINSTATED.

**REFERENCES**

TYPICAL RAISED AIR VALVE CHAMBER (80061155-01-UU-TR5-97-DR-C-00046)

ENVIRONMENTAL MASTERPLAN (5 OF 10, HBC\_RBC\_BMBC-HW-FIG-020-001)

**OS MAP REFERENCE**

SD8022

**LEGEND**

- SITE PLANNING APPLICATION BOUNDARY
  - PUBLIC RIGHT OF WAY
  - PROPOSED BELOW GROUND WORKS
  - PROPOSED ABOVE GROUND WORKS
  - AREA TO ACCOMMODATE CONNECTION TO EXISTING UU INFRASTRUCTURE
  - RETAINED WOODLAND/ OTHER VEGETATION
  - REINSTATED WOODLAND/ OTHER VEGETATION
  - PROPOSED TREE
- TO BE REPRODUCED IN COLOUR ONLY**

P03	SMC	JT	DH	Issued for Planning Application	15/10/21
VERSION	AUTH	CHKD	REVD	REASON FOR ISSUE	DATE
S2		Issued for Information			
SUITABILITY CODE		SUITABILITY DESCRIPTION			



UNITED UTILITIES WATER LIMITED  
HAWESWATER AQUEDUCT RESILIENCE PROGRAMME  
ROSSENDALE BOROUGH COUNCIL  
PROPOSED PERMANENT SITE LAYOUT  
TOWNSEND FOLD WTW /  
NEW HALL HEY COMPOUNDS

SCALE 1:2000	SHEET SIZE A3
DRAWING NUMBER 80061155-01-JAC-TR5-97-DR-C-00006	REVISION P03

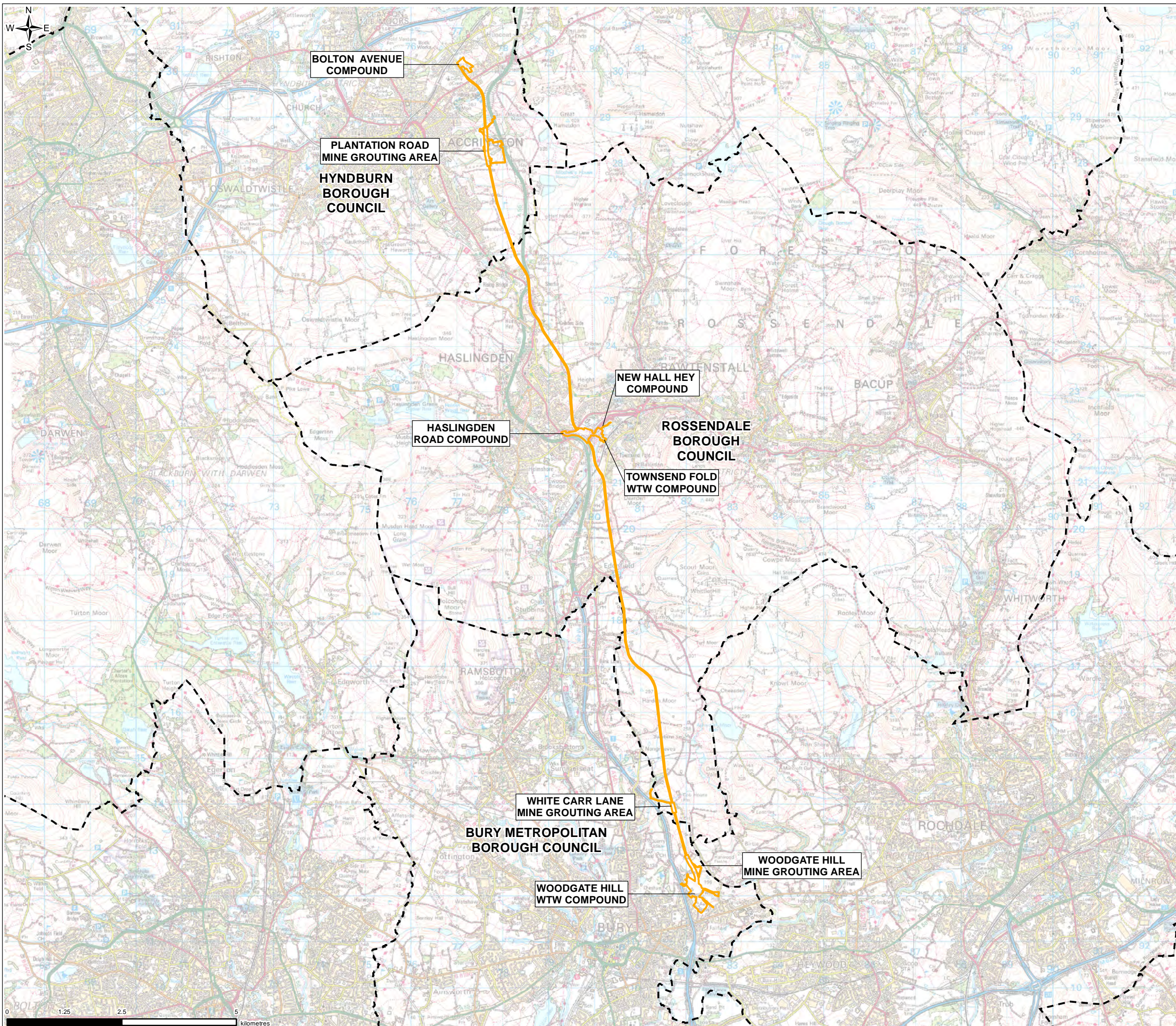

**Legend**  
 Development Envelope Boundary  
 - - - Planning Authority Boundary

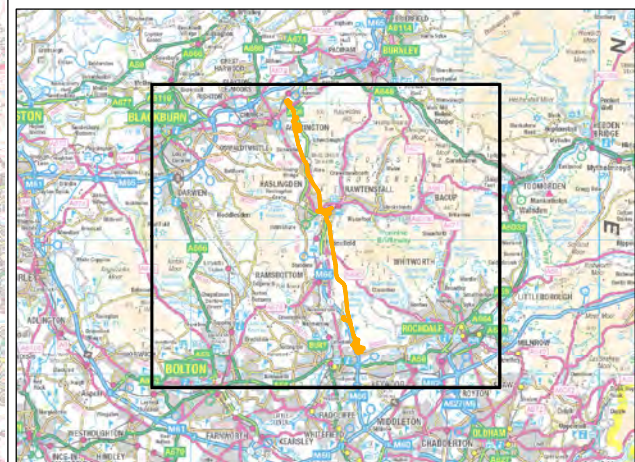

0	SP	BH	AS	Initial Issue	20/04/2021
VERSION	AUTH	CHKD	REVD	REASON FOR ISSUE	DATE









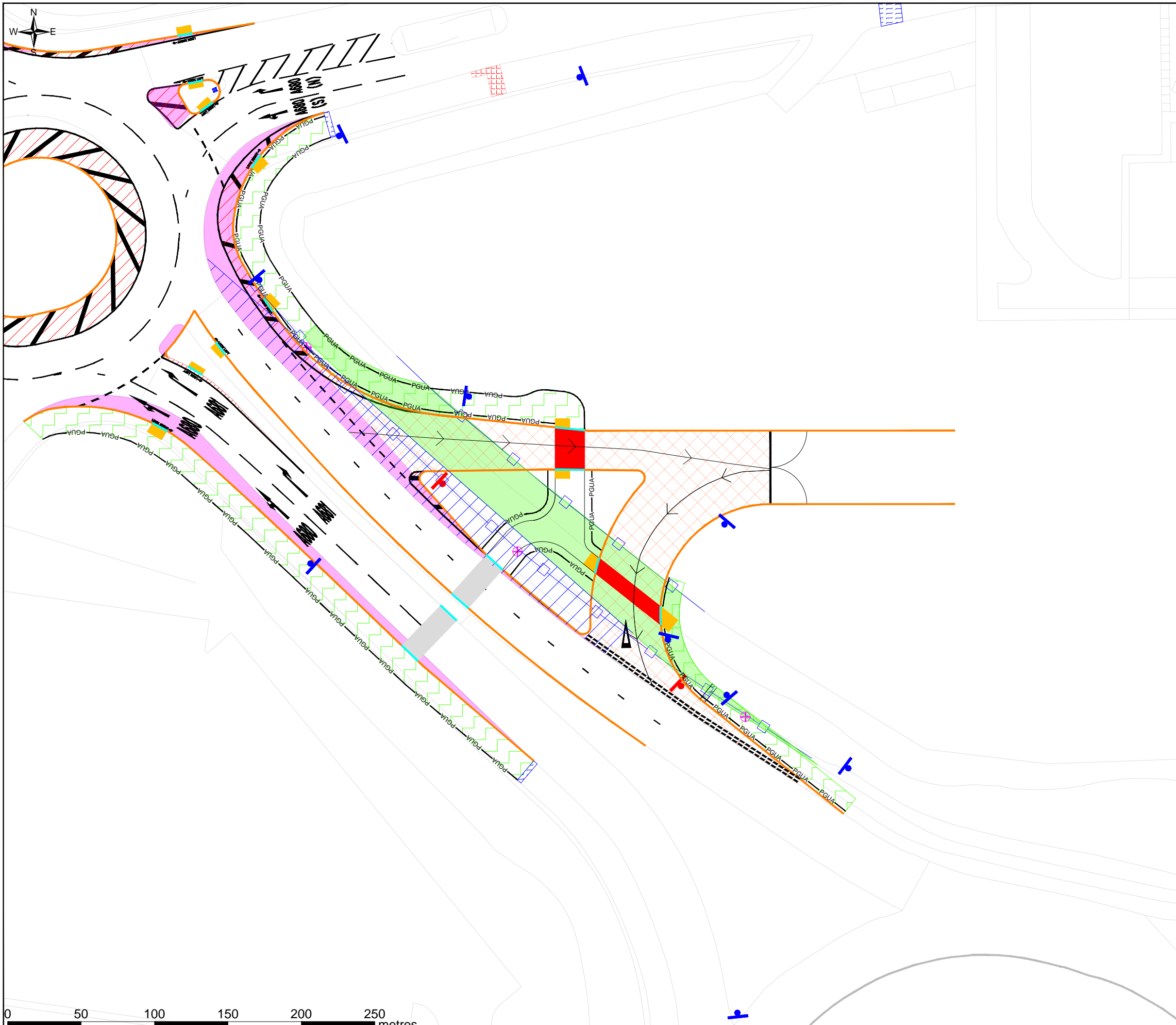













UNITED UTILITIES WATER LIMITED  
 HAWESWATER AQUEDUCT RESILIENCE PROGRAMME  
 HASLINGDEN AND WALMERSLEY  
 ROSSENDALE BOROUGH COUNCIL  
 SECTION OVERVIEW PLAN

SCALE 1:80,000	SHEET SIZE A3
DRAWING NUMBER RBC-HW-APP-004-01-02	REVISION 0

The copyright of this document, which contains information of a proprietary nature, is vested in United Utilities Water Limited. The content of this document may not be used for purposes other than that for which it has been supplied and may not be reproduced, either wholly or in part, in any way whatsoever. It may not be used by, or its contents divulged to any other person whatsoever without the prior written permission of United Utilities Water Limited. Copyright Acknowledgement: Use of Ordnance Survey map data sanctioned by the controller of H.M. Stationery Office. OS Licence Number 100019326. Crown copyright reserved. Unauthorised production infringes copyright. © Crown copyright and database rights 2020 Ordnance Survey 0100031673. Contains OS data © Crown copyright and database right 2020. Contains public sector information licensed under the Open Government Licence v3.0.



- Legend**
-  FULL HEIGHT KERBS 125mm UPSTAND (ST5 BED & HAUNCH)
  -  VISIBILITY SPLAY (INCLUDING VEGETATION CLEARANCE WHERE NECESSARY)
  -  VEGETATION CLEARANCE
  -  PROPOSED HAZARD BLISTER PAVING
  -  PROPOSED PEDESTRIAN RESTRAINT SYSTEM/GUARDRAIL
  -  EXISTING CYCLE CROSSING
  -  PROPOSED REALIGNED FOOTWAY
  -  PROPOSED HOT ROLLED ASPHALT WITH COLOURED (RED) AGGREGATE/CHIPPINGS
  -  PROPOSED BULLNOSE KERB TO BE LAID FLUSH
  -  PROPOSED ACCESS CARRIAGEWAY SURFACE CONSISTING OF RED BINDER WEARING COURSE GREY LIMESTONE COATED WITH RED BIND/HRA WITH RED - COATED CHIPPINGS OR SIMILAR APPROVED BY LHA
  -  PROPOSED SITE GATES
  -  PROPOSED TRAFFIC SIGN
  -  EXISTING TRAFFIC SIGN TO BE RELOCATED
  -  EXISTING FENCING TO BE REMOVED
  -  EXISTING LIGHTING COLUMN TO BE RELOCATED
  -  MAX GRADIENT OF 4%
  -  GUIDED CROSSING 'SCHOOL CROSSING PATROL' OR SIMILAR
  -  PROPOSED 'KEEP LEFT' BOLLARD
  -  PROPOSED CORDUROY PAVING
  -  EXISTING HAZARD BLISTER PAVING TO BE RECONFIGURED

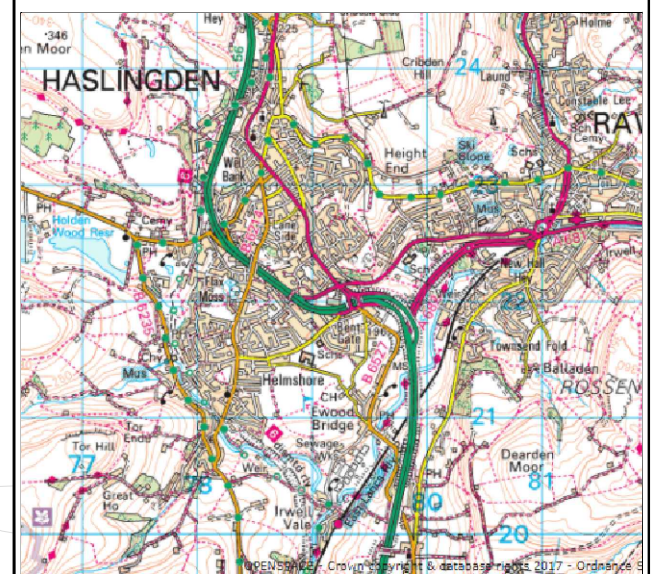

2	LB	SP	SP	FOR PLANNING	APR 2022
VERSION	AUTH	CHKD	REVD	REASON FOR ISSUE	DATE



UNITED UTILITIES WATER LIMITED  
 HAWESWATER AQUEDUCT RESILIENCE PROGRAMME  
 COMPOUND JUNCTION ACCESS DETAILS  
 HASLINGDEN ROAD COMPOUND

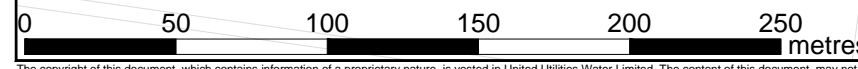

SCALE 1:500	SHEET SIZE A3
DRAWING NUMBER RBC-HW-APP-004-11_01	REVISION 2

The copyright of this document, which contains information of a proprietary nature, is vested in United Utilities Water Limited. The content of this document may not be used for purposes other than that for which it has been supplied and may not be reproduced, either wholly or in part, in any way whatsoever. It may not be used by, or its contents divulged to any other person whatsoever without the prior written permission of United Utilities Water Limited.  
 Copyright Acknowledgement: Use of Ordnance Survey map data sanctioned by the controller of H.M. Stationery Office. OS Licence Number 100019326. Crown copyright reserved. Unauthorised production infringes copyright