

**Welcome to
Rossendale Borough Council's
Development Control Committee
5th September 2023**

Item B1

**2023/0192 - Land Off Goodshaw Avenue
North**

**Full: Erection of a single 4 bedroom residential
dwelling with associated landscaping and
parking**

Proposed Plans, Elevations & Site Plan



Landscaping and Separation Distances

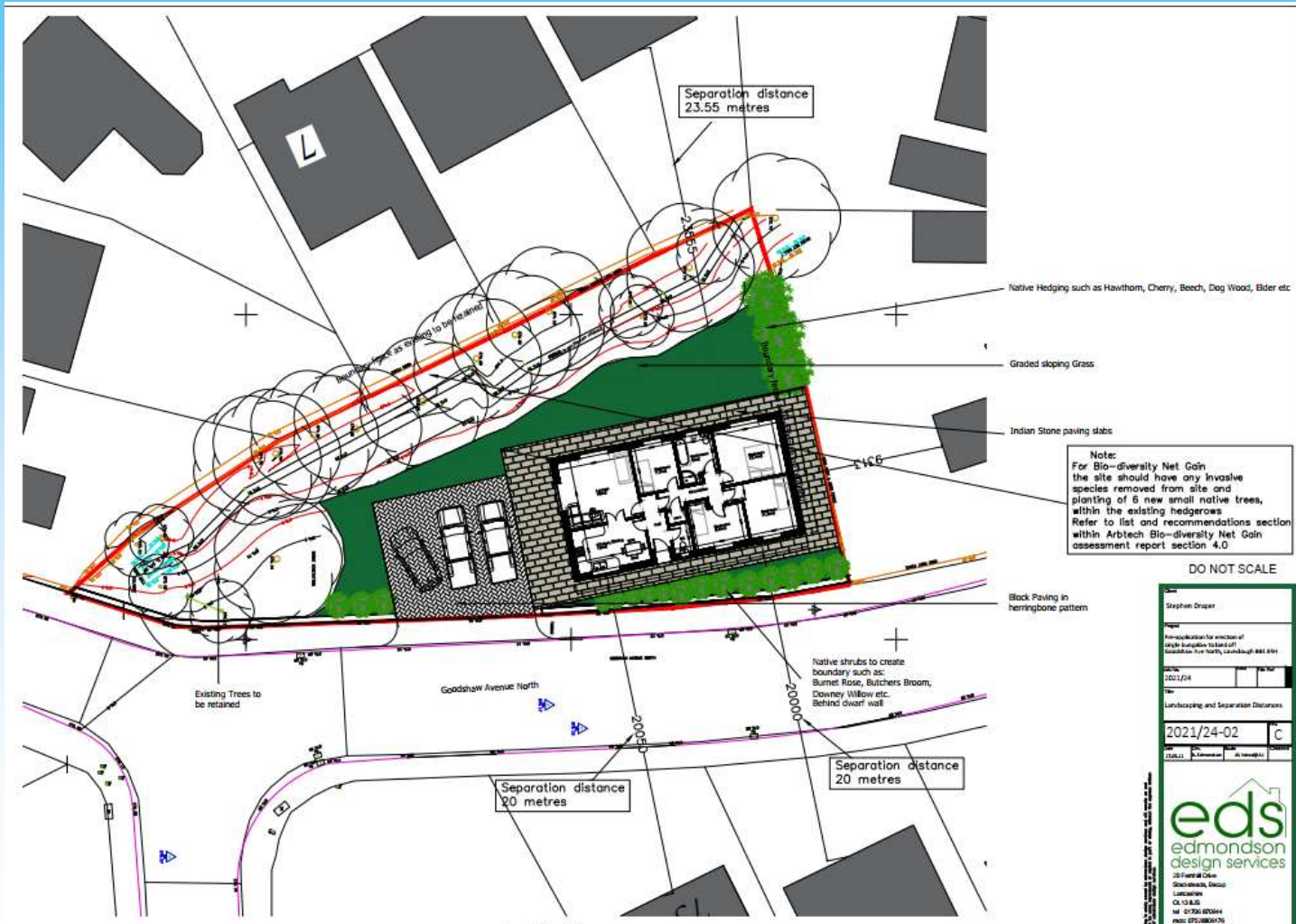
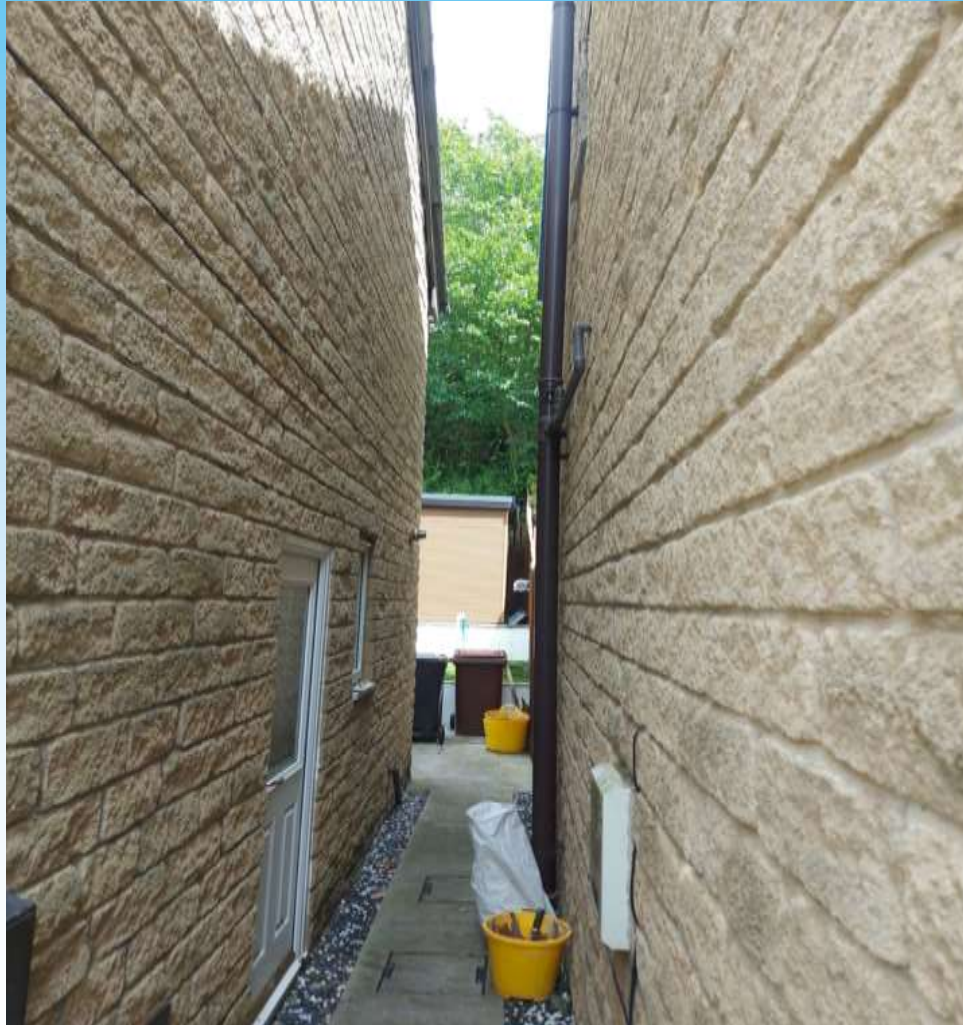

Photo – From Turf Meadow



Photo – From Turf Meadow



Photograph



Photograph



Photograph



Item B2

**2023/0103 – All Saints Rc Language
College, Haslingden Road, Rawtenstall,
BB4 6SJ**

Full: demolition of the main school building and language centre (Use Class F1a), erection of replacement education facility (Use Class F1a) and photovoltaic panels, with associated vehicle and cycle parking, refuse store and outdoor recreation facilities.

Site Location Plan

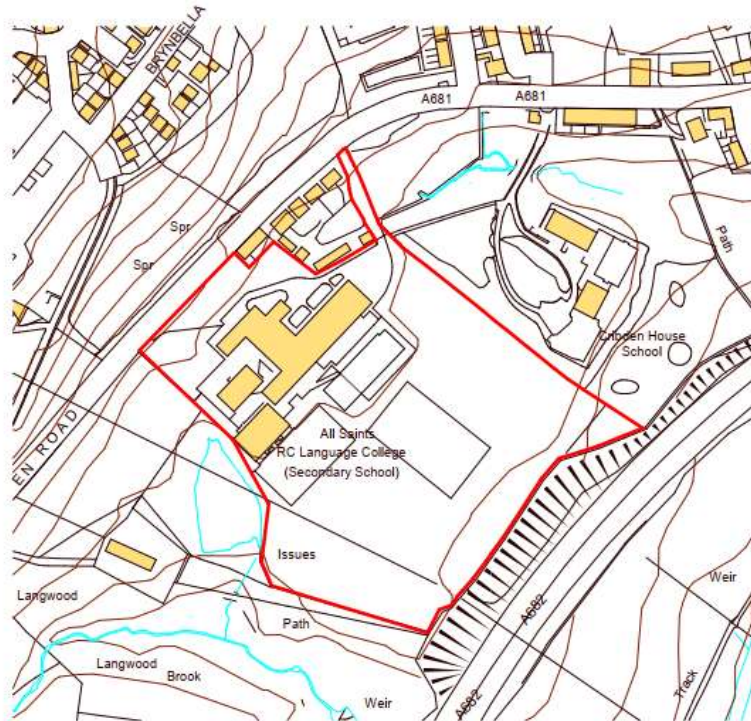

NOTES

Copyright © Ellis Williams. This drawing and its contents are the property of Ellis Williams. No part of this drawing may be reproduced without the written permission of Ellis Williams.

No.	Date	Name	By	Chk.
PI	06.03.20	Preparation	MB	JL
PI	06.03.20	Stage 2 Issue	MB	JL
PI	06.03.20	Stage 3 Issue	JL	MB

1 | A8-1_Site-Location



elliswilliams

Project Number: 1871
Project Name: A8-Banks MB

Drawing Status: Stage 1
Drawing Number: BPP1801-0106-23-23-D1-A-0001
Drawing Name: A8-Location Plan
Date: 06.03.20
Drawn By: MB
Revised By: JL
Scale: 1:1000

© Ellis Williams. All Rights Reserved. 100% Confidential.
11, 12 & 13, The Old Mill, 100% Confidential. 100% Confidential.

Site Plan



Existing Site Plan With Proposed School



Photograph



Photograph



Photograph



Photograph



Item B3

**2023/0142 – Land West Of 1162 Burnley
Road, Loveclough, BB4 8QY**

**Outline Application (including access
only) for residential development of up to
40 dwellings.**

Location Plan



Parameter Plan



Concept Plan



Proposed Site Access

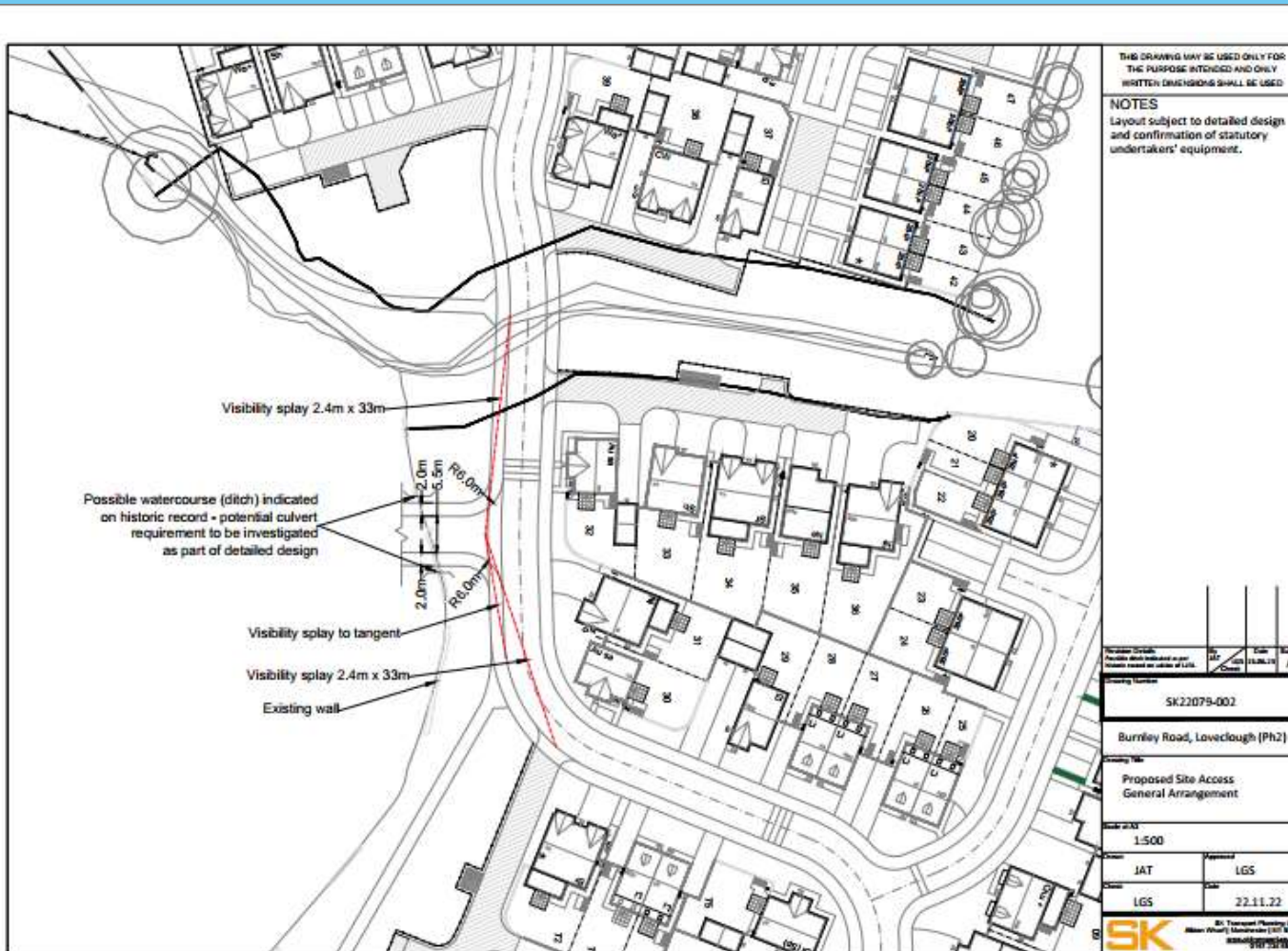

Photograph



Photograph



Photograph



Photograph



Photograph



Item B4

**2022/0391- Cribden Flatts Farm, Cribden
End Lane, Haslingden, BB4 8UB**

**Full: Application for an agricultural building
(inc. biomass boiler)**

Site Location Plan

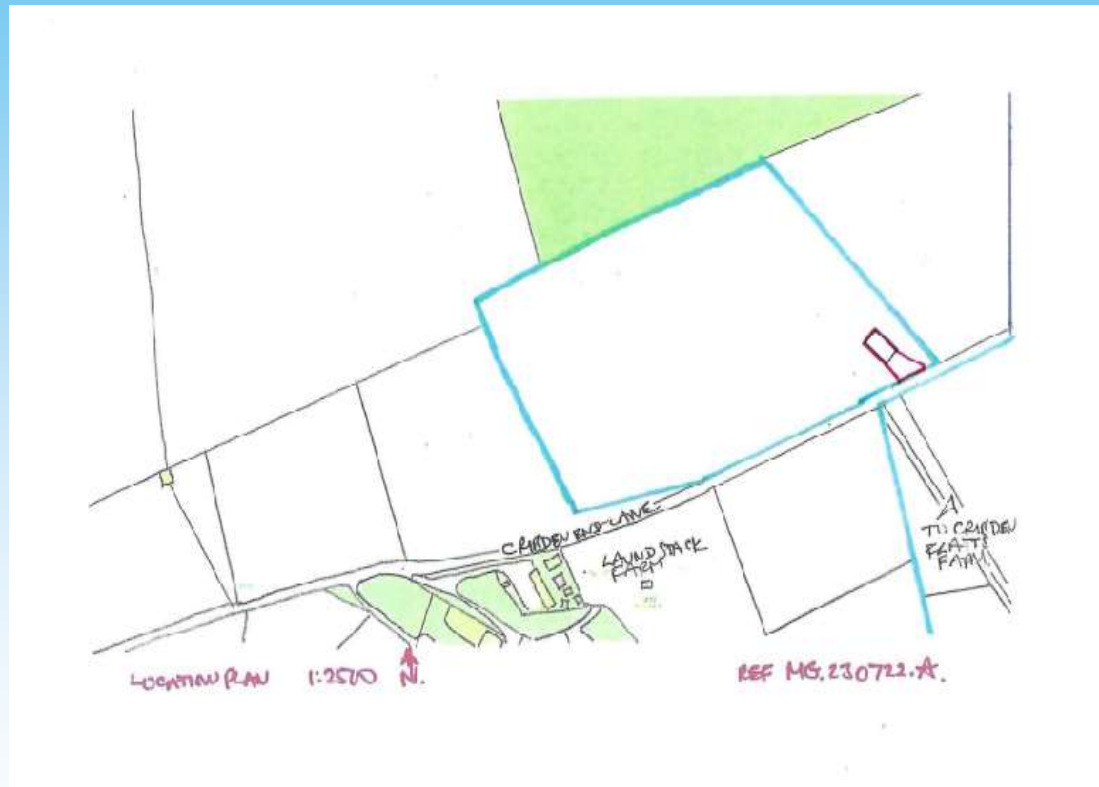

Plans and Elevations

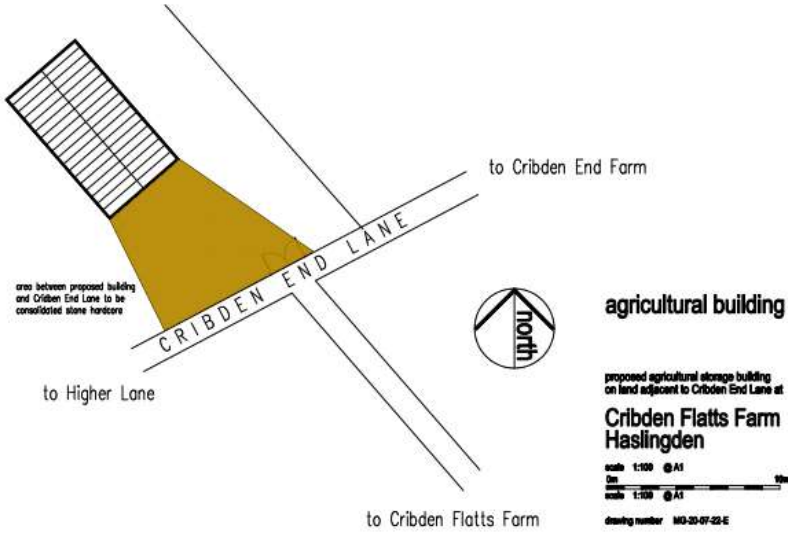
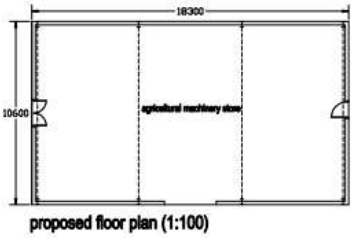
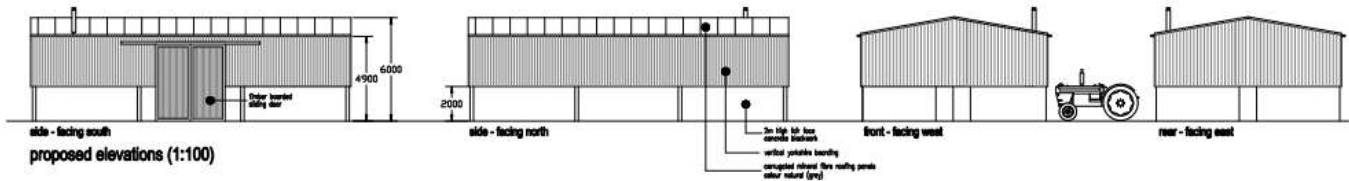

Photograph



Photograph



Photograph



Photograph



Item B5

**2023/0285- Jolly Sailor Inn, Booth Road,
Waterfoot, BB4 9BD**

**Change of use of Public House (Sui Generis)
and C3 residential to form 4 1 bedroom flats
(C3) with associated parking, cycle storage and
bin storage**

Location Plan

Project: The Jolly Sailor PH, 23 Booth Road, Waterloo BB4 9BQ

Project No.: 2023-27

Title: OS Site Plan

Scale: 1:1250@A4

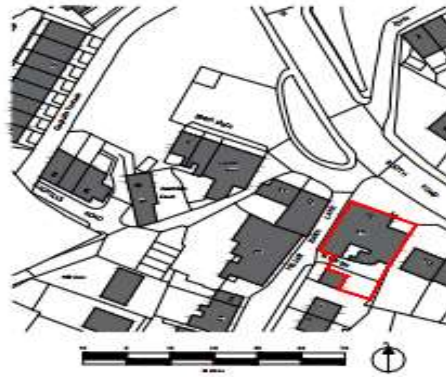

10 Fernhill Drive
Hocksteads, Bacup
Lancashire
OL13 8JS
mob: 07528809176
el 01706 870944

eds edmondson
design services

Existing And Elevations



Proposed And Elevations



Photograph



Photograph



Photograph



Photograph



Photograph



Item B6

**2023/0341- Clairemoor House, Tonacliffe
Way, Whitworth, OL12 8SN**

**Proposed Change of Use to Childrens'
Residential Care Home**

Site Plan and Location Plan

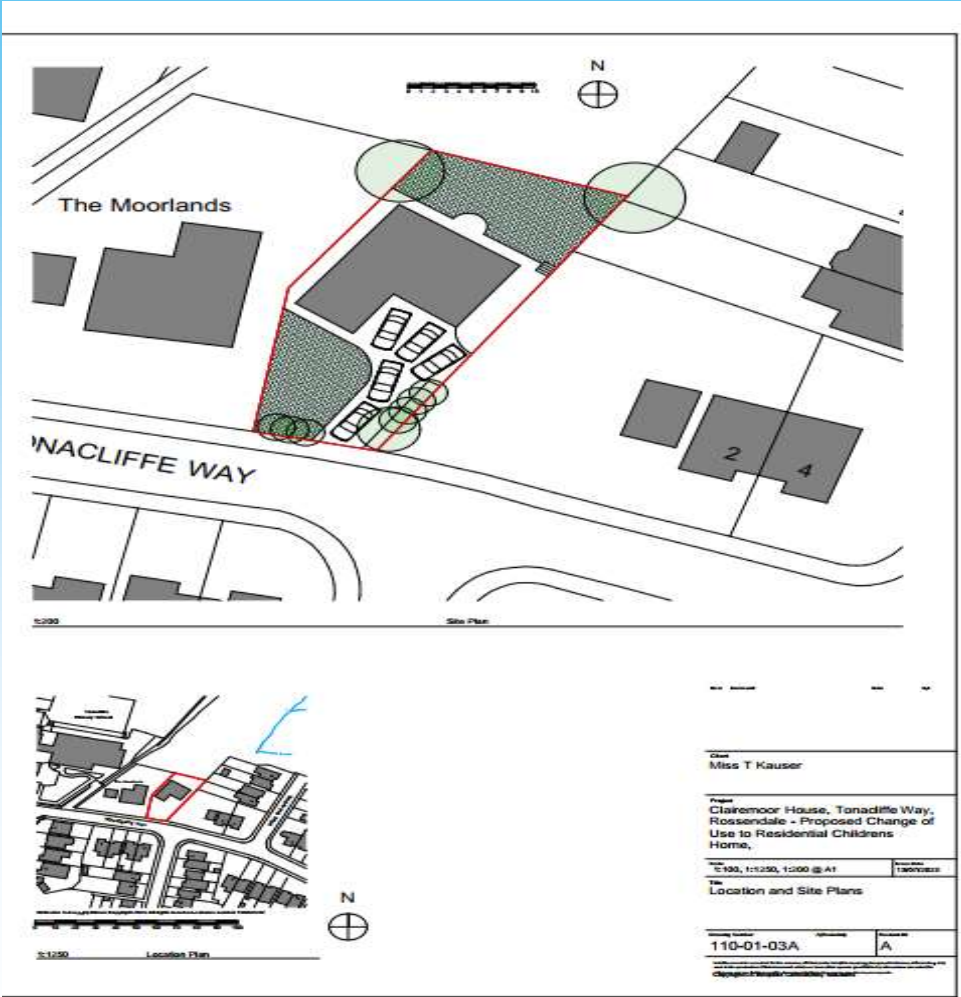

Plans As Existing



Plans As Proposed

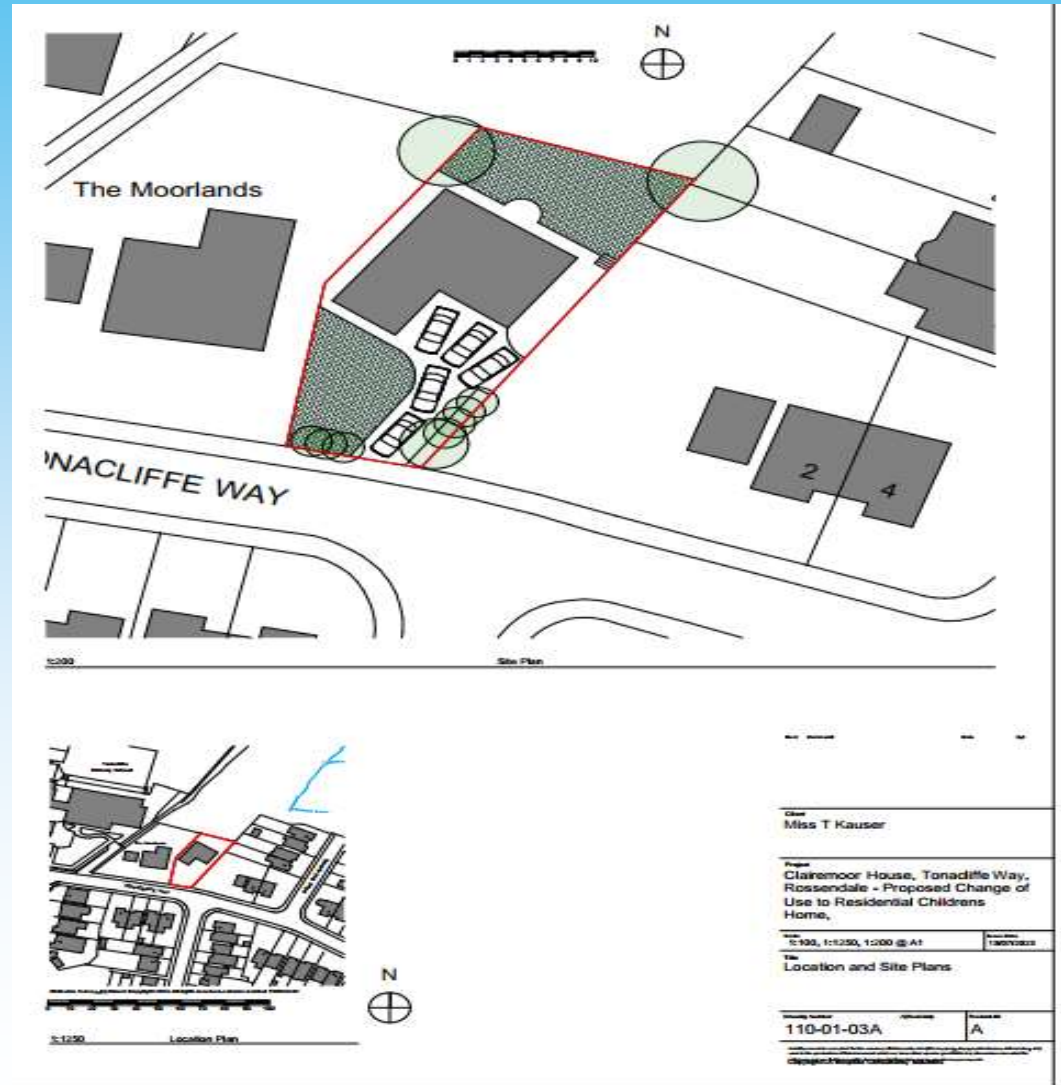

Photograph



Photograph



Photograph

