

SECTION THROUGH PLOT 5C
SECTION 1 ON SITE LAYOUT.

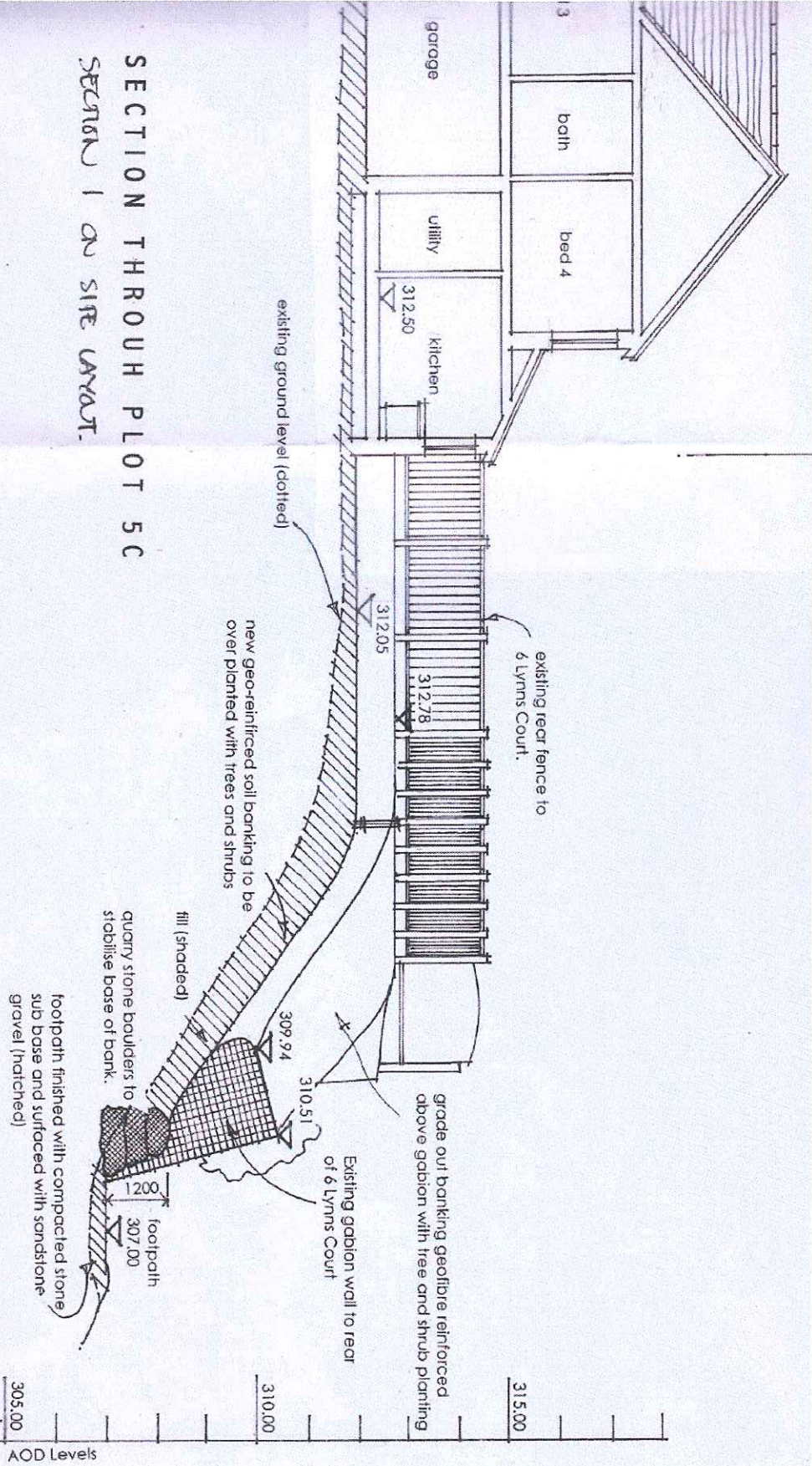

Client **woodstream**
 project **housing development**
 location **lymns court, weir**

architectural consultancy **tony deakin**
 newland villas
 69 stanfield road
 todmorden

scale 1:100 ws.jc.31 march 2016 07598 958 966