

This drawing is copyright and owned by Liberata Ltd. and is for use on this site only unless contractually stated otherwise.
 DO NOT SCALE this drawing (printed or electronic versions). Contractors must check all dimensions from site.
 All other design team elements, where indicated, have been imported from the consultant's drawings and reference should be made to the individual consultant's drawings for exact setting out, size and type of component.
 Discrepancies and / or ambiguities within this drawing, between it and information given elsewhere, must be reported immediately to the architect for clarification before proceeding.
 All works are to be carried out in accordance with the latest British Standards and Codes of Practice unless specifically directed otherwise in the specification.
 Responsibility for the reproduction of this drawing in paper form, or if issued in electronic format, lies with the recipient to check that all information has been replicated in full and is correct when compared to the original paper or electronic image. Graphical representations of equipment on this drawing have been co-ordinated, but are approximations only. Please refer to the Specifications and / or Details for actual sizes and / or specific contractor construction information.
 This original document is issued for the purpose indicated below and contains information of confidential nature. Further copies and circulation will be strictly in accordance with the confidentiality agreement under the contract. This original must be destroyed or returned to the contractor.
SAFETY, HEALTH AND ENVIRONMENTAL INFORMATION
 Refer to the relevant Construction (Design and Management) documentation where applicable.
 It is assumed that all works on this drawing will be carried out by a competent contractor, working where appropriate to an approved method statement.

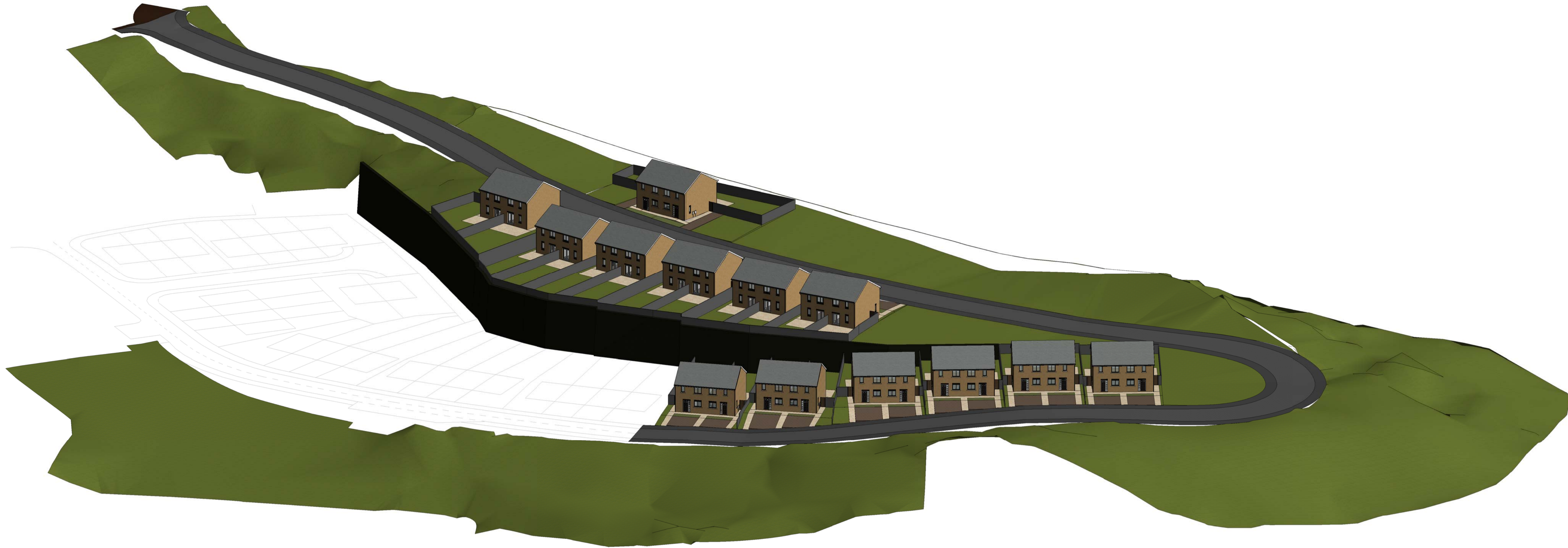

1 3D View - Site 1

- Levels shown are indicative, Civil Engineers to confirm level requirements
- Boundary line to be checked in relation to site ownership
- Topo survey required for previous phase buildings and junction with recently constructed road
- Indicative retaining wall shown, further survey information required



2 3D View - Site 2

B	Planning Submission	19/01/2018
A	Issued for Discussion	08/01/2018

Rev	Description / By / Chk'd / App'd	Date
-----	----------------------------------	------

Purpose of Issue
PLANNING

Client
Barnfield Homes

Project
Rockcliffe Road

Drawing
Proposed Site 3D's

Scale @ A1
1 : 10

Project No.
A1729

Date
01/08/18

Drawing Identifier
A1729-LIB-S1-A1 01-ZZ-LL-3D-001

Liberata
 Property Services

No. 1 Market Street, Nelson, BB97LJ
 T +44 (0) 1282 878787 F +44 (0) 1282 878993
 www.liberata.com

Registered office: Liberata UK Limited, 1st Floor, 100 Wood Street, London EC2V 7AN
 (Registered in England and Wales - No 1238274)

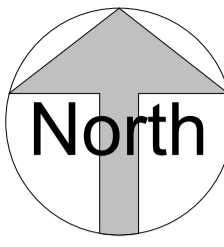

This drawing is copyright and owned by Liberata Ltd. and is for use on this site only unless contractually stated otherwise.
 DO NOT SCALE this drawing (printed or electronic versions). Contractors must check all dimensions from site.
 All other design team elements, where indicated, have been imported from the consultant's drawings and reference should be made to the individual consultant's drawings for exact setting out, size and type of component.
 Discrepancies and / or ambiguities within this drawing, between it and information given elsewhere, must be reported immediately to the architect for clarification before proceeding.
 All works are to be carried out in accordance with the latest British Standards and Codes of Practice unless specifically directed otherwise in the specification.
 Responsibility for the reproduction of this drawing in paper form, or if issued in electronic format, lies with the recipient to check that all information has been replicated in full and is correct when compared to the original paper or electronic image. Graphical representations of equipment on this drawing have been co-ordinated, but are approximations only. Please refer to the Specifications and / or Details for actual sizes and / or specific contractor construction information.
 This original document is issued for the purpose indicated below and contains information of confidential nature. Further copies and circulation will be strictly in accordance with the confidentiality agreement under the contract. This original must be destroyed or returned to the contractor.
SAFETY, HEALTH AND ENVIRONMENTAL INFORMATION
 Refer to the relevant Construction (Design and Management) documentation where applicable.
 It is assumed that all works on this drawing will be carried out by a competent contractor, working where appropriate to an approved method statement.

- Levels shown are indicative, Civil Engineers to confirm level requirements
- Existing levels are based off previous scheme construction drawings
- Topo survey required for previous phase buildings and junction with recently constructed road
- Indicative retaining wall shown, further survey information required

- Previous Developed Scheme
- Proposed Public Right of Way
- Indicative Retaining Wall Location
- Site Boundary

C	Boundary Line Amended	31/01/2018
B	Planning Submission	19/01/2018
A	Issued for Discussion	08/01/2018

Rev Description / By / Chk'd / App'd Date
 Purpose of Issue
PLANNING
 Client
Barnfield Homes

Project
Rockcliffe Road

Drawing
Proposed Site Plan

Scale @ A1 Drawn Checked Approved
 As indicated DW AH NSJ

Project No. Date
A1729 01/08/18

Drawing Identifier
 project origin building model class zone level type number revision
A1729-LIB-S1-A1 01-ZZ-LL-P2-001 C

Liberata
 Property Services
 No. 1 Market Street, Nelson, BB97LJ
 T +44 (0) 1282 878787 F +44 (0) 1282 878993
 www.liberata.com
 Registered office: Liberata UK Limited, 1st Floor, 100 Wood Street, London EC2V 7AN
 (Registered in England and Wales - No 1238274)

1 001 - Proposed Site Plan
 1 : 500

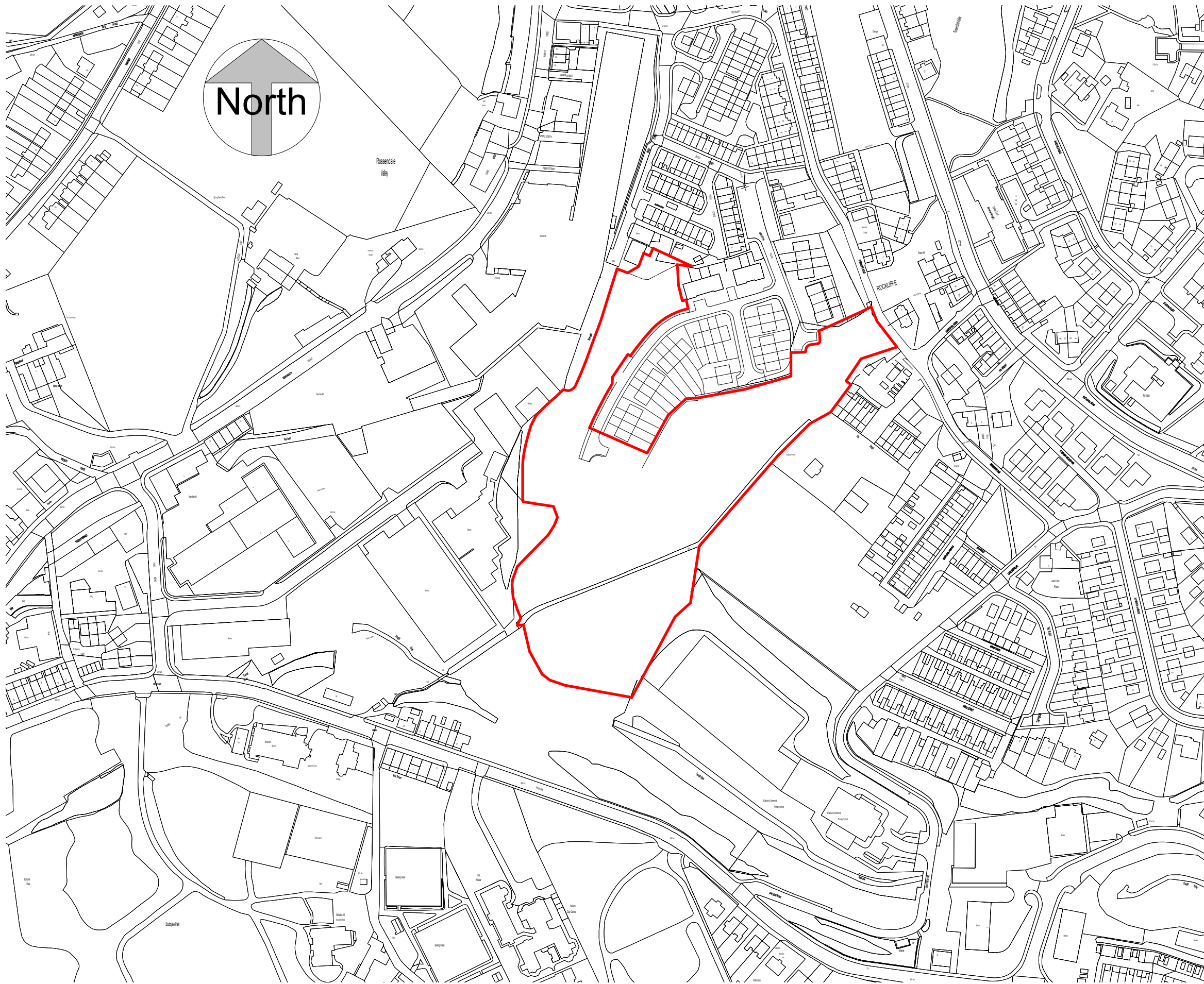

This drawing is copyright and owned by Liberata Ltd, and is for use on this site only unless contractually stated otherwise.

DO NOT SCALE this drawing (printed or electronic versions). Contractors must check all dimensions from site.

All other design team elements, where indicated, have been imported from the consultant's drawings and reference should be made to the individual consultant's drawings for exact setting out, size and type of component.

Discrepancies and / or ambiguities within this drawing, between it and information given elsewhere, must be reported immediately to the architect for clarification before proceeding.

All works are to be carried out in accordance with the latest British Standards and Codes of Practice unless specifically directed otherwise in the specification.

Responsibility for the reproduction of this drawing in paper form, or if issued in electronic format, lies with the recipient to check that all information has been replicated in full and is correct when compared to the original paper or electronic image. Graphical representations of equipment on this drawing have been coordinated, but are approximations only. Please refer to the Specifications and / or Details for actual sizes and / or specific contractor construction information.

This original document is issued for the purpose indicated below and contains information of confidential nature. Further copies and circulation will be strictly in accordance with the confidentiality agreement under the contract. This original must be destroyed or returned to the contractor.

SAFETY, HEALTH AND ENVIRONMENTAL INFORMATION

Refer to the relevant Construction (Design and Management) documentation where applicable.

It is assumed that all works on this drawing will be carried out by a competent contractor, working where appropriate to an approved method statement.

C	Boundary Line Amended	31/01/2018
B	Planning Submission	19/01/2018
A	Issued for Discussion	08/01/2018

Rev	Description / By / Chk'd / App'd	Date
-----	----------------------------------	------

Purpose of Issue
PLANNING

Client
Barnfield Homes

Project
Rockcliffe Road

Drawing
Location Plan

Scale @ A3	Drawn	Checked	Approved
1 : 2500	DW	AH	NSJ

Project No.	Date
A1729	01/09/18





Drawing Identifier	revision
project origin building model class zone level type number	
A1729-LIB-S1-A1 01-ZZ-LL-P2-002	C

Liberata
Property Services

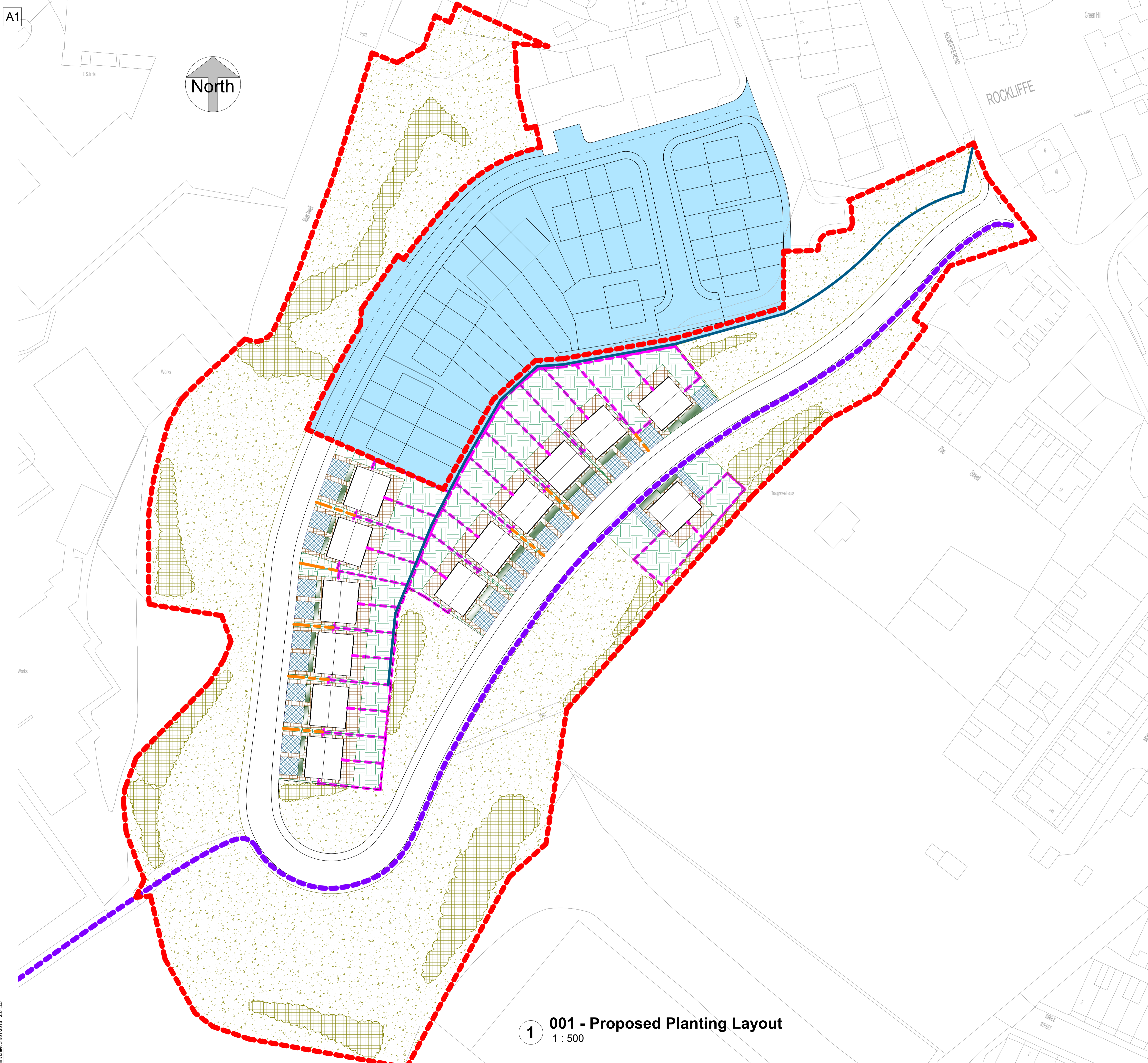
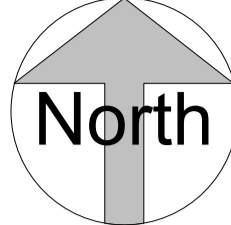
No. 1 Market Street, Nelson, BB97LJ
T +44 (0) 1282 878787 F +44 (0) 1282 878993

www.liberata.com
Registered office: Liberata UK Limited, 1st Floor, 100 Wood Street, London EC2V 7AN (Registered in England and Wales - No 1238274).



-  Previous Developed Scheme
-  Proposed Public Right of Way
-  Indicative Retaining Wall Location
-  Site Boundary

This drawing is copyright and owned by Liberata Ltd. and is for use on this site only unless contractually stated otherwise.

DO NOT SCALE this drawing (printed or electronic versions). Contractors must check all dimensions from site.

All other design team elements, where indicated, have been imported from the consultant's drawings and reference should be made to the individual consultant's drawings for exact setting out, size and type of component.

Discrepancies and / or ambiguities within this drawing, between it and information given elsewhere, must be reported immediately to the architect for clarification before proceeding.







All works are to be carried out in accordance with the latest British Standards and Codes of Practice unless specifically directed otherwise in the specification.

Responsibility for the reproduction of this drawing in paper form, or if issued in electronic format, lies with the recipient to check that all information has been replicated in full and is correct when compared to the original paper or electronic image. Graphical representations of equipment on this drawing have been co-ordinated, but are approximations only. Please refer to the Specifications and / or Details for actual sizes and / or specific contractor construction information.

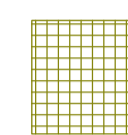
This original document is issued for the purpose indicated below and contains information of confidential nature. Further copies and circulation will be strictly in accordance with the confidentiality agreement under the contract. This original must be destroyed or returned to the contractor.

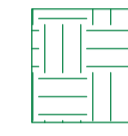
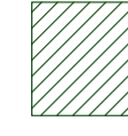
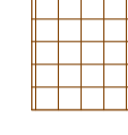
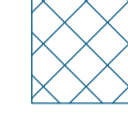
SAFETY, HEALTH AND ENVIRONMENTAL INFORMATION
Refer to the relevant Construction (Design and Management) documentation where applicable.

It is assumed that all works on this drawing will be carried out by a competent contractor, working where appropriate to an approved method statement.

-  Woodland Planting
-  Wildflower Grass
Heathland, acid or marshy grassland
Seed to be proposed where appropriate
-  Grass Lawn
-  Shrub Planting
-  Concrete Flagstones
-  Bitumen Macadam
-  1100mm high close board timber fence with retaining wall below as required
-  1500mm high close board timber fence with additional 300mm trellis top section (1800mm overall)
-  Boundary line, 1100mm high timber post and rail fence to required areas, existing boundary condition to be assessed (areas may vary)

Additional planting of fruit-bearing species, as per the species list below across the site (to supplement badger foraging resource)

Bramble (*Rubus Fruticosus*) / Elder (*Sambucus Nigra*) / Oak (*Quercus Petraea* or *Quercus Robur*) / Bird Cherry (*Prunus Padus*) / Guelder Rose (*Viburnum Opulus*) / Hazel (*Corylus Avellana*) / Hawthorn (*Crataegus Monogyna*) / Dog Rose (*Rosa Canina*)

C	Boundary Line Amended	31/01/2018
B	Planning Submission	19/01/2018
A	Issued for Discussion	08/01/2018

Rev	Description / By / Chk'd / App'd	Date
-----	----------------------------------	------

Purpose of Issue
PLANNING

Client
Barnfield Homes

Project
Rockcliffe Road

Drawing
Proposed Landscape & Planting Plan

Scale @ A1 Drawn Checked Approved
As indicated

Project No. Date
A1729 01/08/18

Drawing Identifier
project origin building model class zone level type number revision
A1729-LIB-S1-A1 03-ZZ-LL-P2-001 C

Liberata
Property Services

No. 1 Market Street, Nelson, BB97LJ
T +44 (0) 1282 878787 F +44 (0) 1282 878993
www.liberata.com

Registered office: Liberata UK Limited, 1st Floor, 100 Wood Street, London EC2V 7AN (Registered in England and Wales - No 1238274)

1 001 - Proposed Planting Layout
1 : 500